

Proposed Traffic Calming Concord Road at Reformatory Branch Trail

Map by Bedford Public Works
September 2024

0 20 40 Feet
1 inch = 40 feet



The information displayed on this or any other map produced by the Town of Bedford is for reference purposes only. The Town of Bedford does not guarantee the accuracy of the data. Users are responsible for determining the suitability for their own individual needs.
All information is from the Town of Bedford's Geographic Information System (GIS) database. Any questions or concerns should be addressed to the Town GIS Analyst.

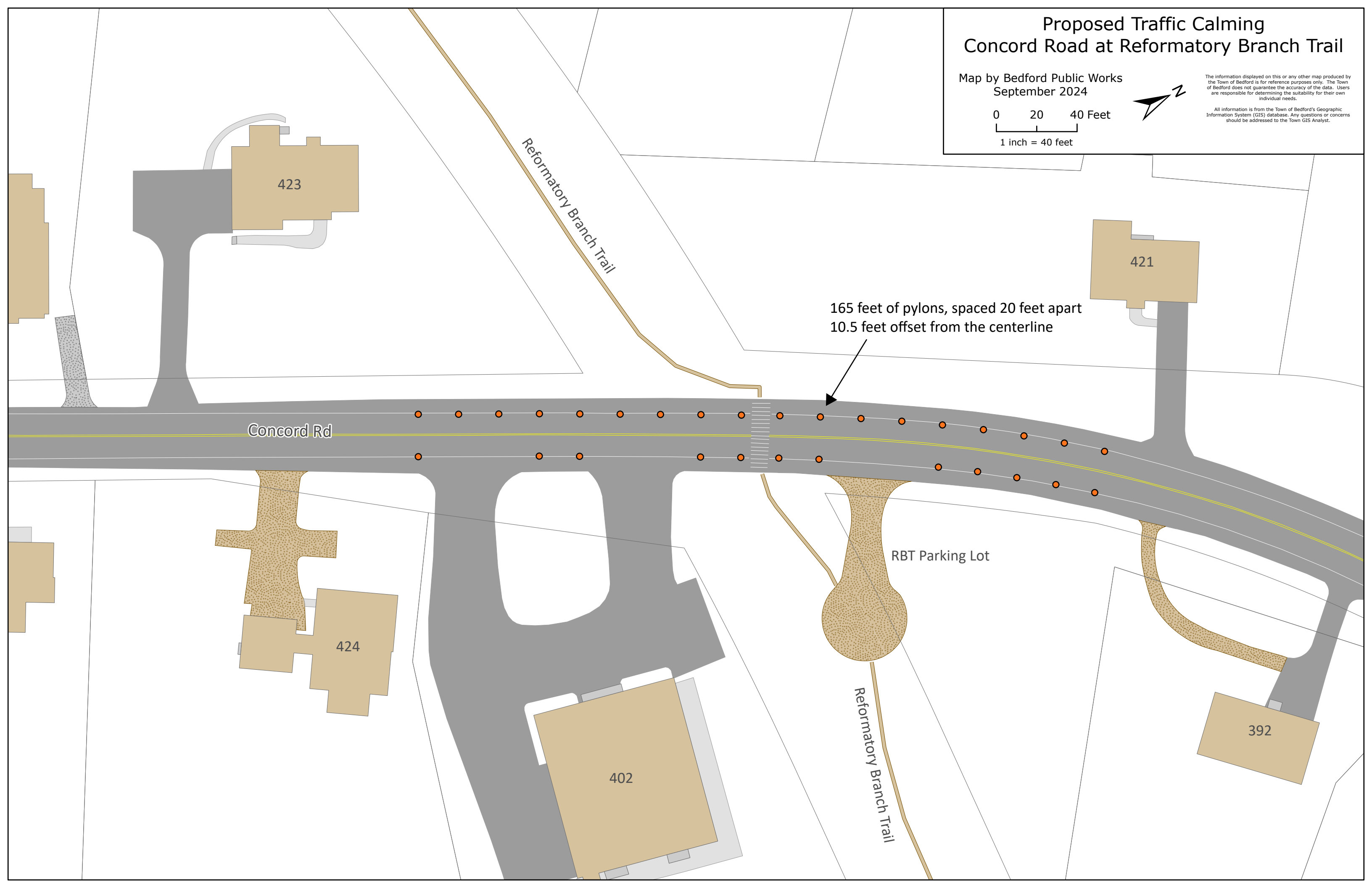

Concord Rd

Reformatory Branch Trail

165 feet of pylons, spaced 20 feet apart
10.5 feet offset from the centerline

RBT Parking Lot

Reformatory Branch Trail

423

421

424

402

392